



Shift+

Recreating the learning environment.

Systems approach. pg. 4

Holistic solution. pg. 12

Inherent flexibility. pg. 20

Shift+

Shift+ is about providing a unique set of tools, enabling the end users to create their own environments. Responding to a multitude of teaching and learning styles simultaneously. Fulfilling the needs of the specific occupants of the space at a precise point in time.

Shift+ is not about reinventing the classroom, it is about blending historic education values and strategies with newly demonstrated pedagogy in the 21st century landscape.

Systems approach.

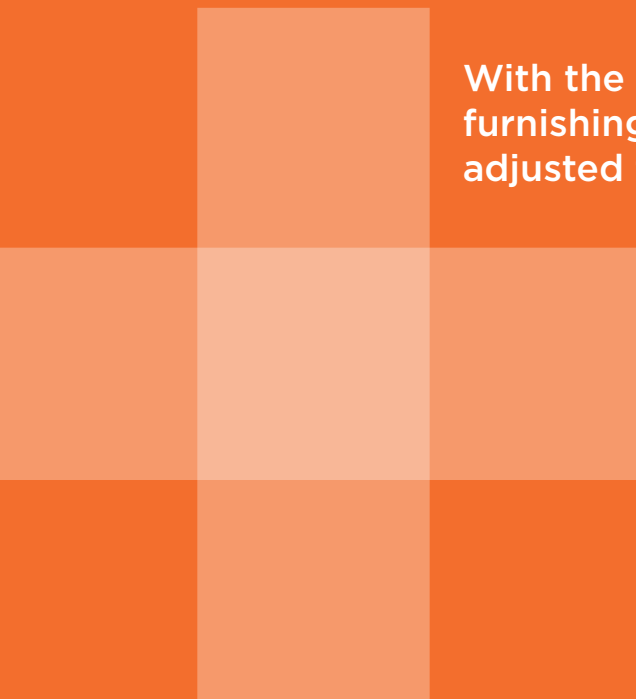

With the help of functional and easy to arrange furnishings, spaces become flexible and can be quickly adjusted to the changing instructional requirements.

Shift+

Differentiation in instruction. The modern school day has a diverse rhythm. Working as a class alternates with learning alone or in a group, and there are also rest periods. The spatial situation must, therefore, be changeable on short notice – allowing, for example, a large circle of chairs as well as a teacher-centered lecture or concentrated quiet work.

With Shift+ spaces can quickly adjust to changing requirements. Pupils and teachers are in a position to make new configurations themselves, without having to call on others for assistance. In this way, the classroom gains new perspectives – and additional didactical possibilities.

Recreating the learning environment.

Shift+ is the solution for a flexible furniture structure: Not every student has to have an individual desk at their disposal. This set-up can also be solved by a diversified offering of single and group desks that are used as the situation calls for, as the illustrated sketches below show.

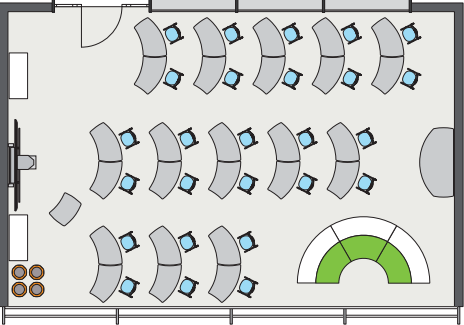

Classic instructional situation

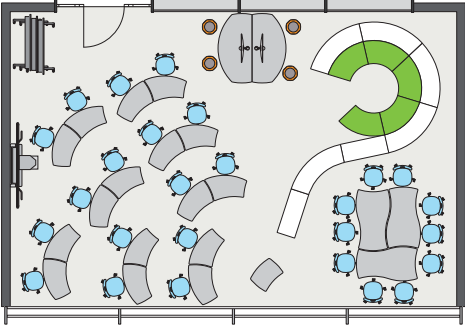

Differentiated learning environment.

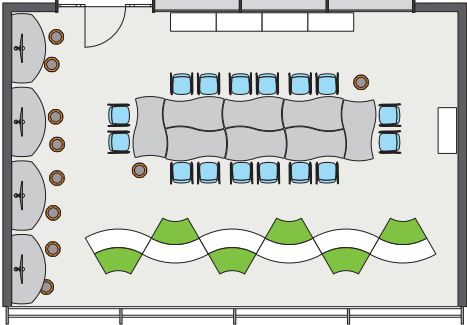

Multi-functional work area.

Shift+



Recreating the learning environment

David A. Stubbs II on the development of Shift+

Shift + was created out of necessity. We realized we were at a crossroads generated by the inherent need to harness a dynamic shifting of educational delivery and instructional models implemented as well as demanded within our facilities. We knew we needed to institute more freedom by the creation of a new idea in educational furniture design. We needed a holistic solution that was complex but at the same time simplistic.

Our goal is to allow the end users to begin with a blank canvas by selecting a set of tools that respond to their specific learning and teaching environments at a precise point in time. We were careful to insure that these tools did not come with accoutrements or components that did not hinder the instructional model. We are allowing the stakeholders to efficiently move selected accessories in and out of the space depending on what they are trying to accomplish.

Shift+ uniquely allows us to support the unlimited variety of learning possibilities and teaching styles in the

most simplistic way possible. Every component within the **Shift+** family is light and mobile. They can be easily reorganized. They can be efficiently stacked, creating open areas. They are not constrained to a specific educational space. They are specifically designed to be transitioned as well as re-purposed throughout a school facility.

Each member within in the family of components, nests within each other in an unlimited set of configurations and arrangements. Storage elements become detached from wall surfaces becoming intragel multi-functional pieces within educational spaces. Technology also becomes mobile as well as transparent with **Shift +**.

The elements of **Shift+** allow the user to continually find new applications - to redefine his individual learning environment every day. The crucial differences **Shift+** offers in school furniture will make educational environments more diverse than ever before.

“The elements of Shift+ allow the user to continually find new applications”

Shift+

THE 8 PRINCIPLES OF SHIFT+

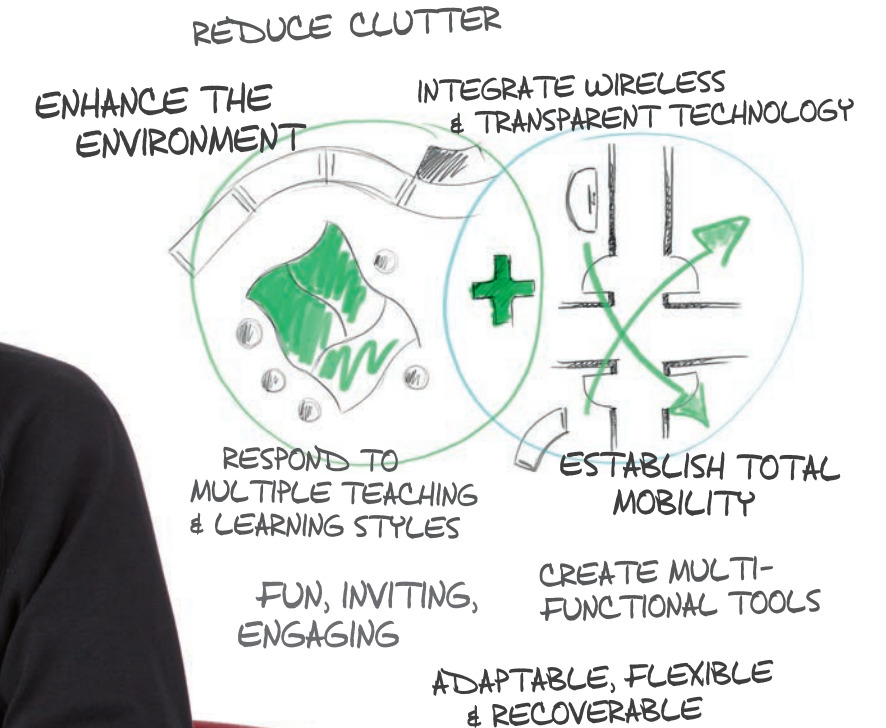



Shift+

Maria Montessori, founder of the Montessori pedagogy, based on independent learning.



Flexible furniture for functional learning landscapes.



The significance of the space.

As a leading school furniture manufacturer, VS early on had already incorporated the educational significance of the spatial environment in the development process. The original Berlin firm of VS had rights to produce and distribute Montessori materials in 1913. Maria Montessori wanted to support children in practicing their abilities themselves. Not only learning materials, but also furniture, spaces and architecture should be adapted to it.



Together with architects and designers, VS is a partner of the international project "The Third Teacher".



The Third Teacher

School architecture, space organization and furniture are said to contribute to activating education potential. The space becomes in this way (with a concept from the Reggio Emilia approach of Loris Malaguzzi) the "third teacher" – in addition to the adults and the other students – and has a decisive influence on the school success of the children. Especially with full-day schools the learning and living area of the school must be set-up in a differentiated and diverse way.



Furniture that promotes movement.

The mind needs the whole body to learn. Monotony in instruction, in combination with constantly sitting still, leads to mental stagnation. The many spontaneous movements of everyday life are of decisive importance for health and performance. This is the only way children can develop fully. For this reason schools today are schools in motion. Movement is integrated into instruction to maintain attention and concentration.

Holistic solution.

Shift+ invites teachers and students to use furniture as needed and to feel comfortable in self-created learning environments.

Seat and Table Heights (ISO/DINEN)

●	h = 11 7/8 20 7/8	No. 2
●	h = 13 3/8 23 1/4	No. 3
●	h = 15 25 1/8	No. 4
●	h = 16 1/2 28	No. 5
●	h = 18 1/8 30	No. 6
●	h = 19 5/8 32 1/4	No. 7



Shift+

Variety without complicated logistics. Shift+ stands for choices and flexibility – for more possibilities in daily use. Shift+ makes furniture available for this purpose, with which teachers and students can develop their own individual learning environment. Situation-specific and always updated, directly coordinated with various instructional phases and didactical concepts. The elements can be applied to a variety of contexts – in classrooms, in the library/media center, in multi-purpose spaces and even in hallways.



Shift+ ThumbPrint
Student table (Convex/Concave)
(wxd) = 38 x 23¹/₄



Shift+ Fusion Flip
Group table (free-form)
(wxd) = 55¹/₂ x 31

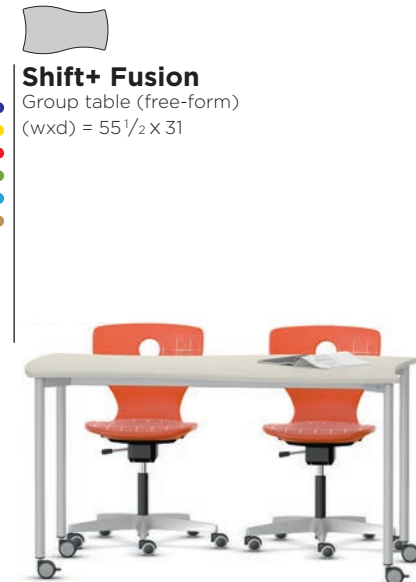

Shift+ Fusion
Group table (free-form)
(wxd) = 55¹/₂ x 31



Shift+ BaseStation
Group table
(wxd) = 63 x 30³/₄



Shift+ Interact
Teacher table
(wxd) = 26³/₈ x 20
(stepless height) = 28-45¹/₄

Shift+ Tables

The basis for modern instruction.

Shift+ Tables form the basic furnishings, which are always needed for daily instruction. Every student is different and learns in multiple ways. **Shift+ Tables** support this high individuality with differentiated configurations which are easy to achieve and meet the most diverse needs.

Shift+ ThumbPrint
Student table (stackable)

A pure, lighter desk with flexible use positions. The convex or concave-shaped table sides increase the combination possibilities and open configurations outside of a rigid design. The tables are mobile and stackable (stackable up to six desks, mobile up to three stacked desks).

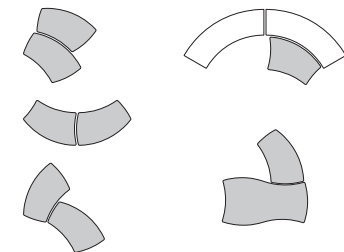

Shift+ Fusion Flip
Group table

Free forming table with foldable top. In this way the desks can be nested together to save space, if they are not in use and are parked in the space as a reserve. If necessary, the mobile group tables are then quickly joined together in a group. The free forming space allows various combinations.

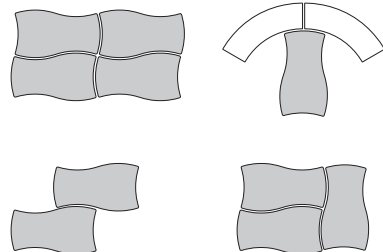

Shift+ Fusion
Group table (four-legged)

The simply-combined, free forming four-legged table can be used for the most diverse group sizes. In addition the desks can be pushed together as needed. Castors on all four table legs provide for problem-free mobility, the desks can be arranged by pupils of all ages.

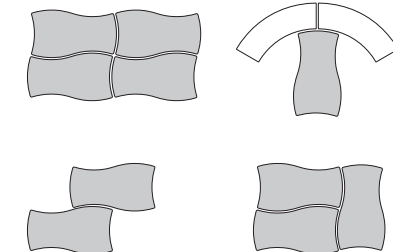

Shift+ BaseStation
Group table (semi-circular)

Mobile five-leg group table with tangential and semicircle side. Because of the common radii of the system this semicircular group table can be integrated directly into various pupil desk configurations. A good wall contact is also provided on the straight side. The table desk can be set up as a mobile computer space, with monitor arm and a CPU that can be integrated.

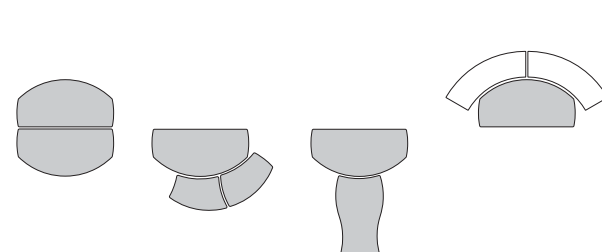

Shift+ Base
Teacher table
(height-adjustable)

The height of the teacher's desk can be smoothly adjusted. With the castors it can be easily moved in the classroom. To ensure unimpeded mobility the work space is compact and the integrated storage space is minimized. Additional requirements are covered by a separate teacher storage module.



Shift+

Tables



Shift+ Landscape

- Seat module, storage module*
(60° wxd) = $43\frac{3}{8} \times 20\frac{7}{8}$
- (Straight wxd) = $41\frac{1}{2} \times 20\frac{7}{8}$
(Storage wxd) = $43\frac{3}{8} \times 20\frac{7}{8}$
-

*Storage module only available in 60° and 16 1/2" height



Shift+ Landscape/Transfer
Maximum mobility made possible.

With the storage space modules and seat modules **Shift+ Landscape** learning environments and differentiated zones within the classrooms can be simply and quickly formed. Storage space at different heights makes different degrees of separation of areas possible. There are also sitting modules per age at different sitting heights.

Shift Landscape

Seat modules
(Straight and 60°)

The straight and 60° seat modules are available in different heights. They offer useful basic elements, as desired, for the organization of group sitting areas with more informal character. The storage space module and seat module can be directly integrated in the free sitting landscape.

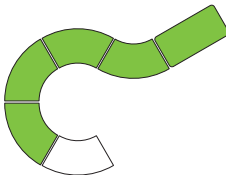

Shift+ Transfer

- Mobile storage modules
(60° wxd) = $60 \times 16\frac{3}{4}$
(Straight/Box wxd) = $42 \times 16\frac{3}{4}$
h = $38\frac{1}{8}$ or $45\frac{1}{2}$



Shift+ Transfer

Mobile storage modules (Straight/Curved/Box)

The mobile storage modules are available in two heights. They can be integrated into various combinations and together with the seat modules creating separated group areas. The modules can also be equipped to accommodate storage boxes. Connecting magnets on each side secure multiple modules together - and thus more flexible configuration.

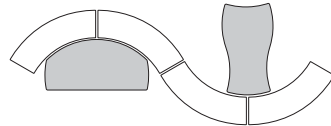
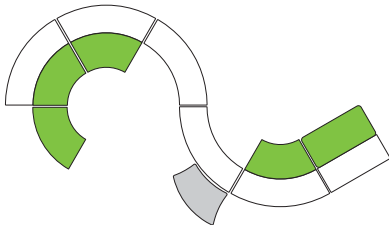

Shift+ Transfer Teach

Mobile teacher storage module
(wxd) = $46\frac{1}{4} \times 18\frac{3}{4}$
h = $45\frac{1}{2}$



Shift+ Transfer Teach

Mobile teacher storage module

Shift+ Landscape makes available, for the needs of the teacher, a mobile storage space module with lockable castors. As a freely mobile module, it can accompany the teacher anywhere in the room or building. All elements of **Shift+** are designed so that mobility doesn't end at the door of the classroom.

Shift+
Landscape/Transfer

Dynamic school
furnishings.
Ergonomic
companions to
Shift+



PantoMove-LuPo
Five-star foot chair



Dynamic sitting.

The swivel chair **PantoMove-LuPo** is easily height adjustable and offers a 3D rocking mechanism. With changes in load, the seat leans forward or back or to either side – and thereby allows the student the freedom of movement that is indispensable for developing a healthy attitude and continuous concentration. The air cushion seat shell offers a high level of comfort.

PantoSwing-LuPo
Cantilever chair



Cantilever chair with comfort.

The cantilever **PantoSwing-LuPo** is equipped with a comfortable air cushion seat shell, which offers comfort throughout a long school day. The seat surface angle changes when weight is shifted forward or back.

B1Chair
Double Cantilever chair



A real talent for movement.

Using double cantilevers and the natural spring of bent steel, the **B1Chair** shifts forward and leans back at the same time. This dual flexing action allows the chair to respond to the body's natural movement and promotes power of concentration and mental mobility.

Hokki
Stool



Playful freedom to move.

The innovative **Hokki** offers controlled freedom of movement. With its rounded off base, it makes movement possible in all directions. The **Hokki** is highly stable, but very light as well. The soft base layer prevents slipping.

Cloud
Beanbag
(wxd) = 41³/₈ x 41³/₈



Pure relaxation.

Pure sitting relaxation is offered with the **Cloud** beanbag. Here the body is permanently in motion, and is continuously animated to a change in the sitting posture. The beanbag is pliable and gives way to every movement. The back is supported and at the same time relieved.

Shift+
...more

Inherent flexibility.



Traditional school furnishings quickly reach their limits when it concerns differentiation. Shift+ is free from such limitations and opens new possibilities.

Shift+

A new set of tools for learning environments. This new set of tools is elegant. **Shift+** can be easily reconfigured to fit an endless variety of educational styles. The tools do not respond to a specific space. They can be utilized in classrooms, collaborative spaces and media centers from K-12 through higher education.

Classroom A (34'x22')

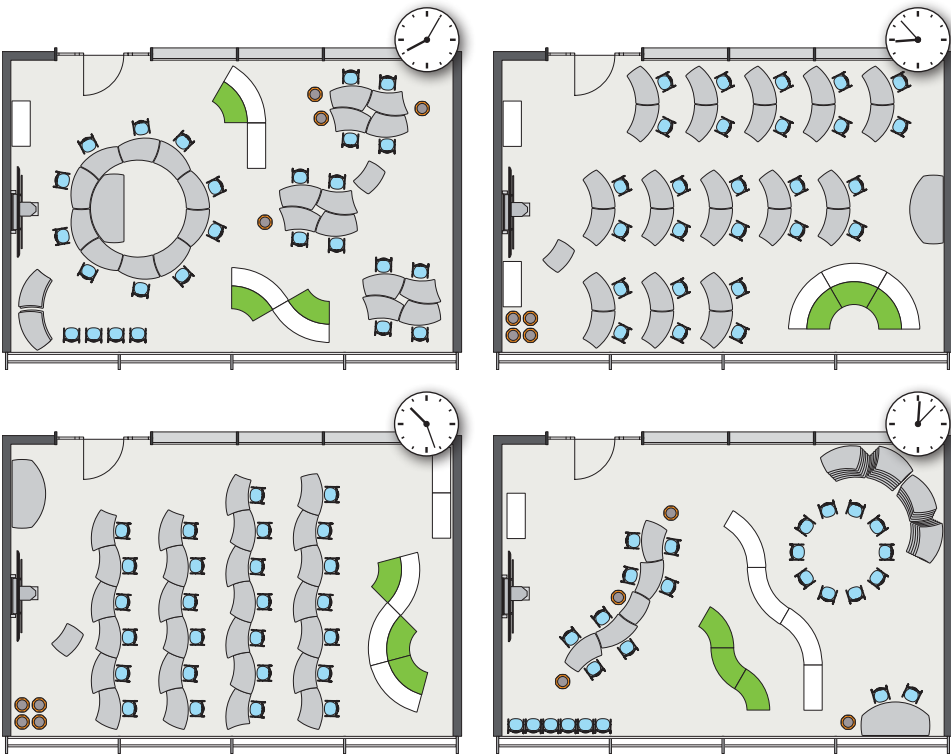

Furniture for 26 students:

- Shift+ Landscape/Transfer**
- 1 Transfer Teach
 - 1 Transfer (Straight)
 - 3 Transfer (60°)
 - 3 Landscape (60°)

- Shift+ Tables**
- 1 Interact
 - 13 ThumbPrint (Convex)
 - 13 ThumbPrint (Concave)
 - 1 BaseStation

- Shift+...more**
- 26 PantoSwing-LuPo
 - 4 Hokki stools

Multi-purpose (34'x22')

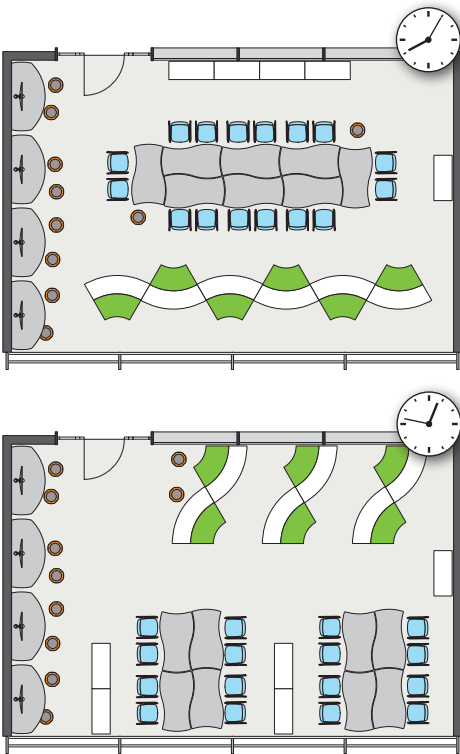

Furniture for 4 computer stations and 16 group places

- Shift+ Landscape/Transfer**
- 6 Transfer (60°)
 - 5 Transfer (Straight)
 - 6 Landscape (60°)

- Shift+ Tables**
- 4 BaseStation (tech)
 - 8 Fusion Flip

- Shift+...more**
- 16 B1Chairs
 - 10 Hokki stools

Classroom B (34'x22')

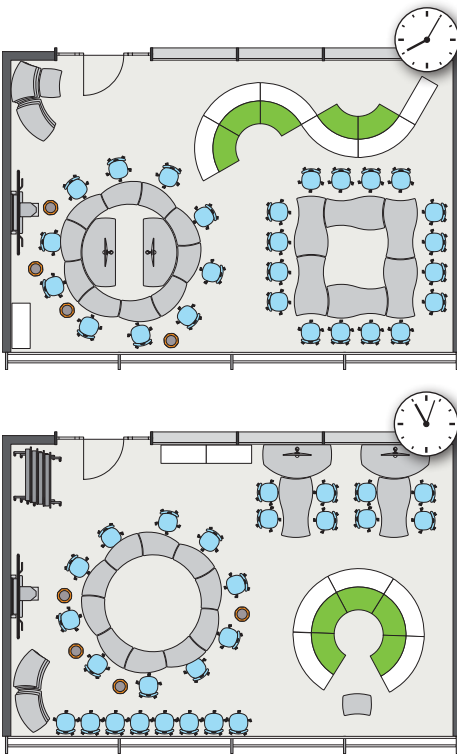

Furniture for 26 students:

- Shift+ Landscape/Transfer**
- 5 Transfer (60°)
 - 2 Transfer (Straight)
 - 5 Landscape (60°)

- Shift+ Tables**
- 1 Interact
 - 8 ThumbPrint (convex)
 - 8 ThumbPrint (concave)
 - 2 BaseStation (Tech)
 - 6 Fusion Flip

- Shift+...more**
- 26 PantoMove-LuPo
 - 4 Hokki stools

Library/Media

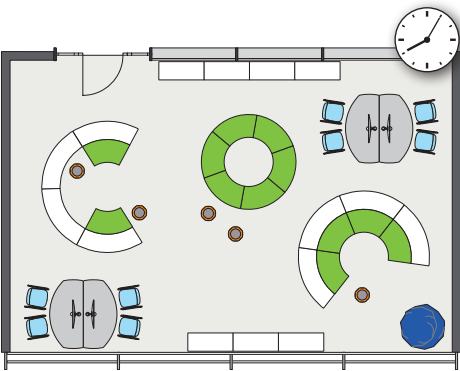

Furniture for 8 workplaces and 13 reading spaces:

- Shift+ Landscape/Transfer**
- 7 Transfer (Straight)
 - 8 Transfer (60°)
 - 12 Landscape (60°)

- Shift+ Tables**
- 4 BaseStation (Tech)

- Shift+...more**
- 8 B1Chairs
 - 5 Hokki stools
 - 1 Cloud (beanbag)

Shift+



Shift+ Transfer Teach
Mobile Teacher
Storage Module

Shift+ ThumbPrint
Student table
(Convex/Concave)

Shift+ Transfer
Mobile storage module
(Straight/60°)

Shift+ BaseStation
Group table

Shift+ Interact
Teacher table

Shift+ Landscape
Seat module



Quick change classroom. (Classroom A)

Shift+ makes it easy to free the furniture from the classroom-central perspective. The student's tables allow for situation-specific uses: central orientation to the teacher, circles, free flowing lines, configurations for partner or group work. Storage and sitting modules are integrated and support the differentiation in the space. Stacked tables form the reserve for further combinations.

Shift+
for 26 students

**Shift+ Transfer**

Mobile storage module
(Straight/60°/Box)

**Shift+ BaseStation**

Group table
(Tech)

**Shift+ Fusion Flip**

Group table

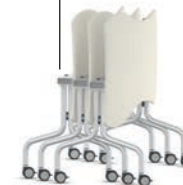
**Shift+ Landscape**

Seat module



Multi-functionality can be found in every element. (Multi-purpose)

Make many things possible with a few basic elements: **Shift+** reduces the number of elements – but provides everyone with many possibilities. The free-form table is not only formally precise, but also offers a variety of uses that transcend the usual standards. Storage space modules create zones in the space. Semicircular computer spaces can be easily integrated in configurations, but can be easily placed against the wall as well.

Shift+

for 4 computer stations
and 16 group spaces



Shift+ BaseStation
Group table
(Tech)



Shift+ Transfer
Mobile storage module
(Straight/60°)



Shift+ ThumbPrint
Student table
(Convex/Concave)



Shift+ Fusion Flip
Group table

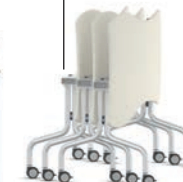

Shift+ Interact
Teacher table



Shift+ Landscape
Seat module



Move from passive to active learning. (Classroom B)

Freedom is the **Shift+** basic principle: Set up the space the way you need it! The furniture is mobile and fits through every classroom door. Desks can be freely integrated into various configurations. A permanent set up of the student with a personal desk can be replaced by alternating use and rotating work between group tables and individual desks.

Shift+
for 26 students



Shift+ BaseStation
Group table
(Tech)



Shift+ Transfer
Mobile storage module
(Straight/60°)



Shift+ Landscape
Seat module



Not only for classroom areas, but for all learning environments. (Library/Media)

Shift+ supports independent work methods of pupils, alone or in a group. So, for example, library areas can be well-furnished with the elements. The semicircular group tables can be designed as computer areas. With the storage modules, mobile units are available if needed. In rounded form, the storage space and sitting modules invite the establishment of optically separated zones for groups.

Shift+
for 8 workplaces
and 13 reading spaces





Shift+ is about making a difference.



Art-No. SHIFT+ 4-1-2014 V01

VS America, Inc.:

**1940 Abbott Street
Charlotte, NC 28203**

**Phone: 704-378-6500
Fax: 704-378-6005**

**info@vs-charlotte.com
www.vs-network.com
facebook.com/vsamericainc**